

## ***INSTALLATION GUIDE FOR PARKING SENSOR MOUNT KIT (BOCNBSKIT-3)***

**Compatible Nudge Bar Models**

**Bocar Deluxe Nudge Bar (BOCN0200)**

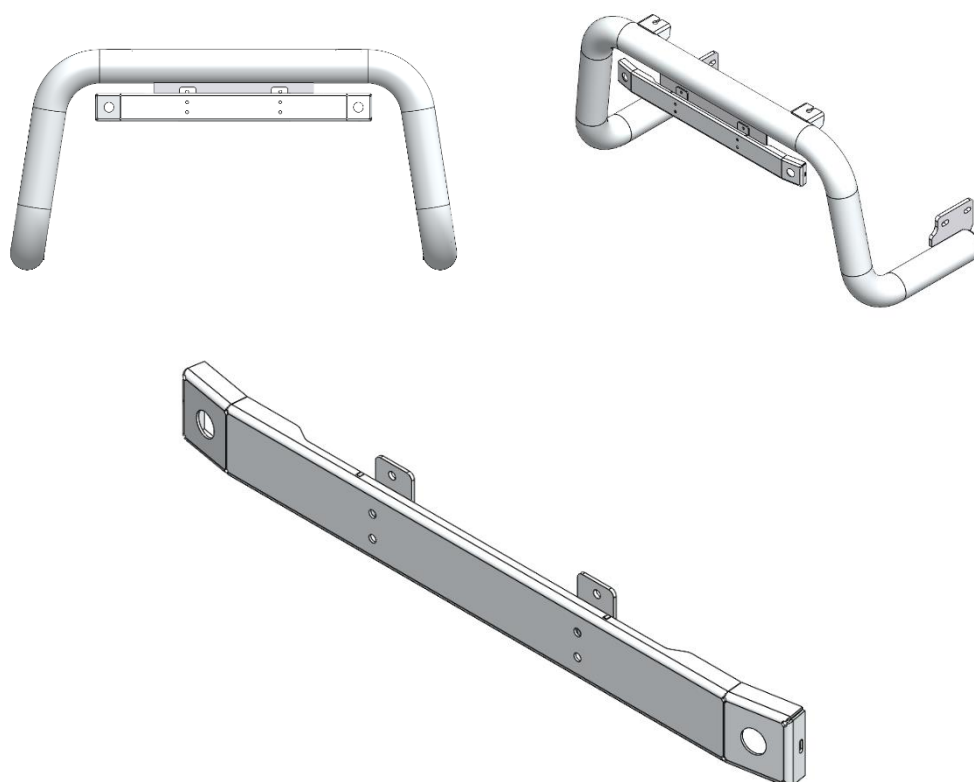

### **Important Notes:**

- This parking sensor mount kit suits the vehicle with inner parking sensors.
- Read instructions completely before commencing fitment.
- Bocar and its affiliated companies are not responsible for any damage that may occur to you or your vehicle during the installation of these products.
  - \* Electrical system damage may be possible due to incorrect wiring or method and is the responsibility of the person fitting.
  - \* Note: Incandescent test lamps are not recommended as damage to vehicle electronics is possible.
  - \* Please consult an auto electrician if you are not comfortable with modifying the vehicles electrical system.
- Do not use this product for any vehicle make or model, other than those specified by the VFPS manufacturer.

Bolt Tensions	Diameter (mm)	Nm
All bolt tensions are as follows unless otherwise specified.	5	5
	6	9
	8	22
	10	44
	12	77

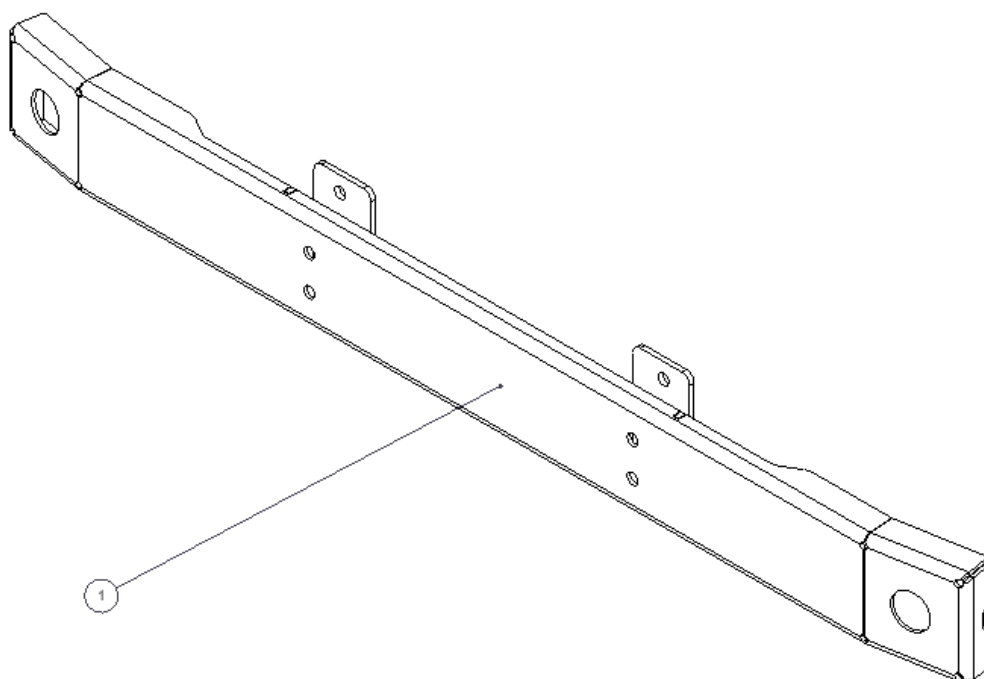

Item No.	Description	Qty	Part No.
<b>SENSOR MOUNT KIT</b>			
1	Parking Sensor Mount	1	BOCN0180

Item No.	Description	Qty	Part No.
<b>BOLT KIT</b>			
N/A	M6 x 1.0 x 20mm Hex Bolt	4	K0550
N/A	M6 x Ø19mm x 1.6mm Flat Washer	6	K2905
N/A	M6 x 1.0 Nyloc Nut	4	K0605



**Before installing the parking sensor mount kit, make sure the followings are in place.**

1. Inner parking sensors (2) have been removed from the OE bumper. This requires the removal of bumper to access the sensors.
2. The wiring harness has been extended 600mm for each inner sensor and covered with convoluted tubing.
3. The Bocar deluxe nudge bar is installed on the vehicle.
4. The number plate and OE plastic backing are removed from the vehicle.

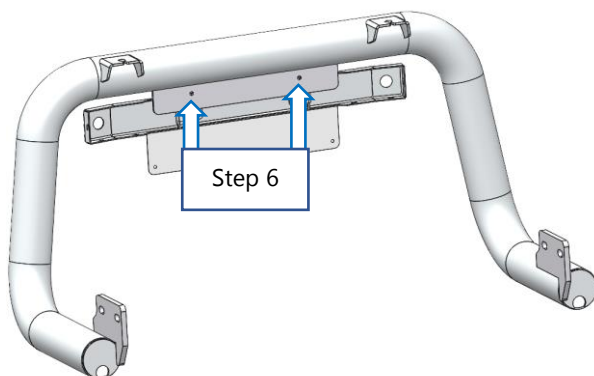
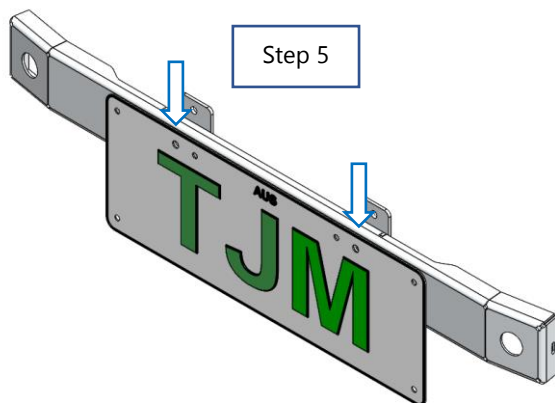

5. Re-attach the number plate onto the sensor mount using M6 x 1.0 x 20mm Hex Bolt (2), M6 x Ø19mm x 1.6mm Flat Washers (2) and M6 x 1.0 Nyloc Nuts (2). Ensure the washers are used on the nut side.
6. Place the sensor mount onto the nudge bar with the cable tie cutouts facing down and use M6 x 1.0 x 20mm Hex Bolts (2), M6 x Ø19mm x 1.6mm Flat Washers (4) and M6 x 1.0 Nyloc Nuts (2) to loosely secure the sensor mount onto the nudge bar.
7. Once happy with the alignment and the orientation of the sensor mount, tighten all fasteners to the torque specified on page 2.

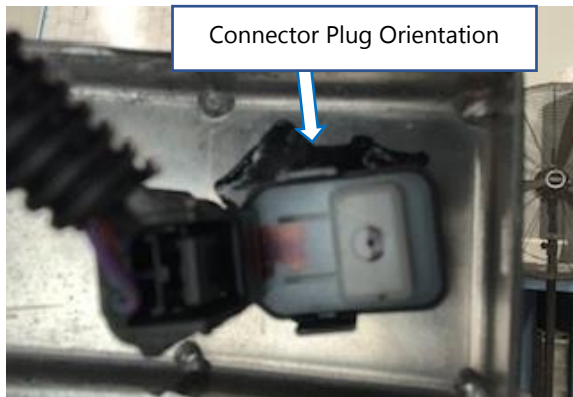

8. Install the OE housings and parking sensors to the Parking Sensor Mount. Ensure that the sensors are installed on the same side of the vehicle and in the same orientation as the OE condition.

**Note: You may need to use some adhesive to ensure the OE housings are secure.**

9. Reconnect the extended wiring harnesses to the parking sensors.
10. Use the cable tie mounts to secure the wiring harness to the sensor mount.

**Note: Parking sensors might not function properly if the orientation of the plug is incorrect.**

11. Securely route and attach the wiring harness to the grille and avoid too much overhang of wiring causing potential damage on paint. Use cable ties if necessary.

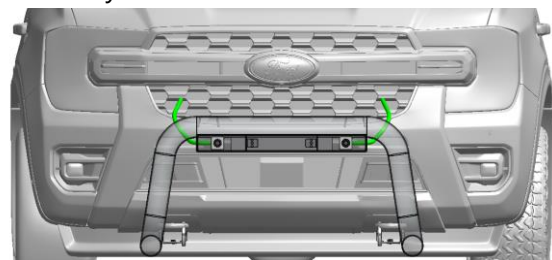

## PRODUCT CARE & INFORMATION

*Customer Copy*

### Corrosion Protection Tips

- Going on an adventure! Be sure to rinse all areas and remove any sand, mud, or debris in and around any areas that can catch this type of matter.
- Going to the beach! Make sure to rinse all salt water and sand off. To improve the longevity and life of this product, be very thorough with fresh water and a sponge.

### Nuts and Bolts

- At Bocar we do not get to experience your adventures or service your vehicle, so be sure to regularly check all nuts and bolts, especially after a large Off-Road trip or regular use on Civil, Mining and construction sites.

### Love Care and Attention

- Planning to drive in a salty environment! If so, spray all fasteners with a Lanolin or WD40 protectant for longevity.
- If you spot a deep scratch touch up with paint to help prevent rust and inhibit corrosion.
- Regularly Wash & Dry the product the same as your vehicle using normal car wash to maintain appearance.

### Modifying Your Vehicle

- Modifications to your vehicle involves some risk, all care has been taken to test driver aids, so they work as the vehicle manufacturer intended. There may be the need to re-calibrate after fitment by the vehicle manufacturer. As the owner of your vehicle the driver remains, responsible for the vehicle always when driving.
- Check and re-tighten any components after your first adventure. Regular upkeep will help you get the most out of your Genuine Bocar Product and your pride and joy.

### Warranty

- 2yr/40,000km. Warranty conditions apply. Our goods come with consumer guarantees that cannot be excluded under the Australian Consumer Law. Our warranty does not limit and may not exceed your rights under those guarantees. For full details on our warranty please refer to [www.bocar.com.au/warranty](http://www.bocar.com.au/warranty)