



FITTING INSTRUCTIONS

Product:	Rock Crawler Rails
Vehicle:	Jeep JK Wrangler 07+ (4 Door)
Part No.	735STRSA36Z

- **Read instructions fully before commencing fitment.**
- **Estimated Fitting Time: 1.5hrs**
- **Left hand and Right hand components are determined as seated in the vehicle.**
- **Check for (and remove) any build up in all captive nuts fitted to the FPS.**

Bolt tensions	Dia. (mm)	Nm	ft.lbs	Dia. (inch)	Nm	ft.lbs
All bolt tensions are as follows unless otherwise specified.	5	5	4	1/4"	9	7
	6	9	7	5/16"	22	15
	8	22	16	3/8"	33	27
	10	44	32	7/16"	55	43
	12	77	57	1/2"	86	66

Warranty

1. If any product or part of a product manufactured by TJM is found to be defective during a period of three (3) years after the date of purchase, TJM shall repair (at TJM's discretion) the defective product or part.
2. Any defect in a product distributed by TJM, but not manufactured by TJM, shall be dealt with in accordance with, and to the extent of, the warranty offered by the manufacturer of that product.
3. TJM does not warranty that the products manufactured by it comply with the laws of the place where those product are purchased or used. It is the sole responsibility of the purchaser to ascertain whether products being purchased, or the affixation of those products to any other object, comply with local laws.
4. Except to the extent described in this warranty, TJM shall not be liable for any other claims, including claims arising from incorrect fitment, product or vehicle modification, faulty design, the use of the product on any indirect special or consequential damage or injury to any person, company or other entity.
5. Modification or alteration to any product manufactured by TJM to enable fitment in conjunction with other vehicle accessories or modifications (e.g. lift kits) will void any warranty claims.

For further information contact T.J.M. Head Office on (07) 3865 9999. Distributors Australia wide.



FITTING INSTRUCTIONS

Product:	Rock Crawler Rails
Vehicle:	Jeep JK Wrangler 07+ (4 Door)
Part No.	735STRSA36Z

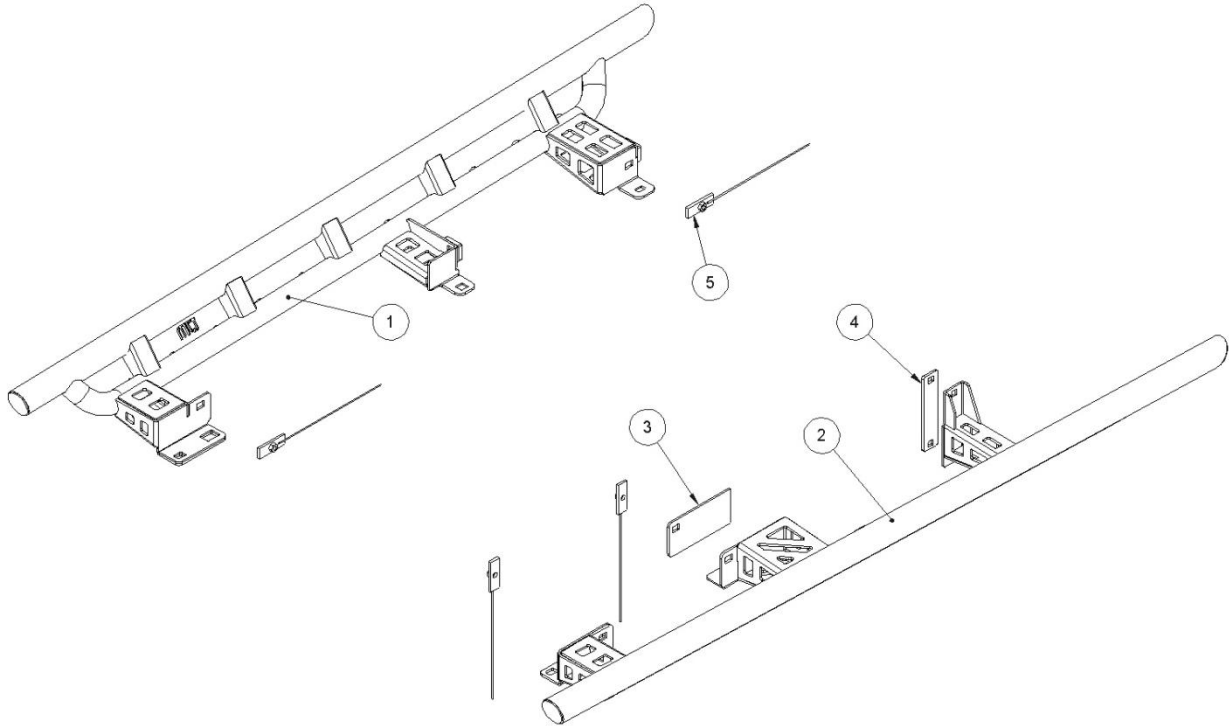

ITEM NO.	Description	Qty	Part Number
PARTS LIST			
1	Rock Crawler Rail RH	1	F-852
2	Rock Crawler Rail LH	1	F-863
FITTING KIT			
3	Spacer Plate	1	F-1422
4	Clamp Plate	1	F-869
5	M10 x 1.25 Nutplate-on-Wire	4	81449

ITEM NO.	Description	Qty	Part Number
BOLT KIT			
N/A	M10 x 1.25 x 30mm Hex Head Screw	6	K0564
N/A	M10 x 1.25 x 90mm Hex Head Bolt	2	K0761
N/A	M10 x 1.25 Nyloc Nut	4	K3099
N/A	M10 Spring Washer	8	K0621
N/A	M10 x Ø30mm Flat Washer	12	WSST-W13



FITTING INSTRUCTIONS

Product:	Rock Crawler Rails
Vehicle:	Jeep JK Wrangler 07+ (4 Door)
Part No.	735STRSA36Z

1. Remove (& discard) the OE steps (& associated fasteners).
2. Remove (& retain) the fastener securing the fuel filter & water trap guard to the chassis rail.
3. Remove (& retain) the side fasteners securing the fuel tank to the chassis rail.
4. Remove (& retain) the fasteners securing the transfer case guard to the chassis rail & allow it to hang from the cross-member/fuel tank.

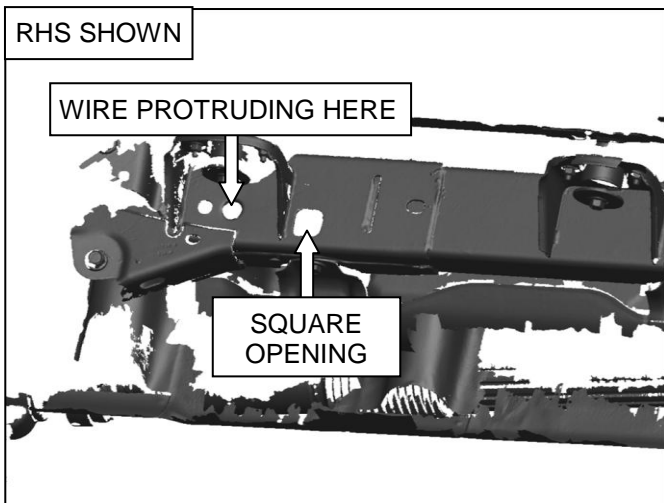

5. On the RHS of the vehicle, insert an M10 x 1.25 nutplate-on-wire (wire end first) into the square opening in the chassis rail (just in front of the rear body mount) & feed the wire along the chassis rail & out through the indicated hole.
6. With the assistance of another person, carefully lift the RH Rock Crawler Rail into position & re-install the fasteners from steps 2 & 3, securing through the respective OE components (tighten the fasteners so that they hold firm, but still allow adjustment).

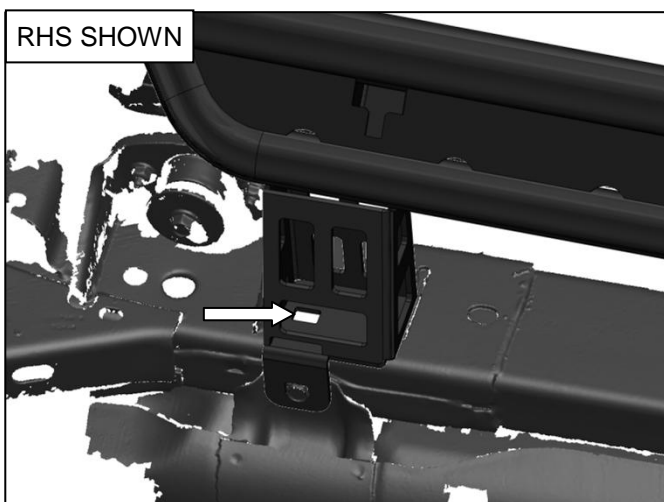

7. On the RHS of the vehicle, aligning the M10 x 1.25 nutplate-on-wire from step 5 with the indicated fastening location, loosely secure it in place, using an M10 x 1.25 x 30mm hex bolt (1), M10 x Ø30mm flat washer (1) & M10 spring washer (1) (tighten the fasteners so that they hold firm, but still allow adjustment).

For further information contact T.J.M. Head Office on (07) 3865 9999. Distributors Australia wide.



FITTING INSTRUCTIONS

Product:

Rock Crawler Rails

Vehicle:

Jeep JK Wrangler 07+ (4 Door)

Part No.

735STRSA36Z

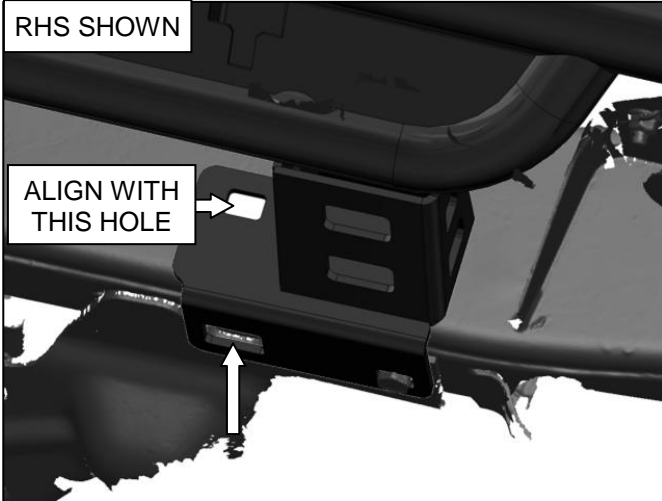

8. On the RHS of the vehicle, insert an M10 x 1.25 nutplate-on-wire into the large square opening in the lower face of the front chassis rail mount & aligning it with the indicated hole, loosely secure it in place, using an M10 x 1.25 x 30mm hex bolt (1), M10 x Ø30mm flat washer (1) & M10 spring washer (1).

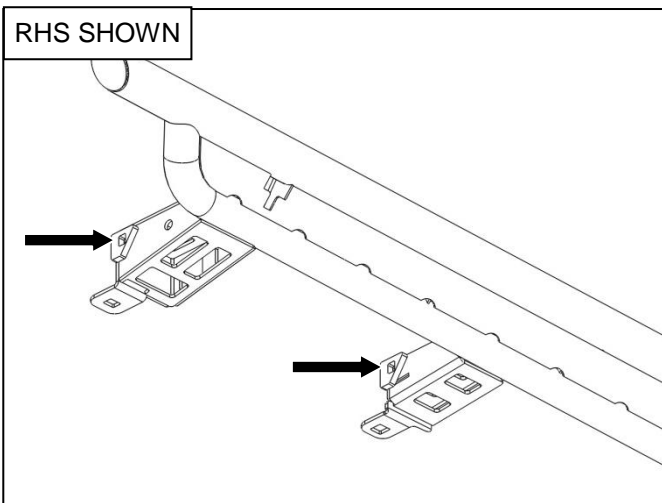

9. Using the indicated holes as a guide, drill a Ø12mm hole through each body mount on the RHS chassis rail.
10. De-burr the edges & clean the area/surface of any swarf/debris, then treat any raw exposed surfaces with a rust preventative.
11. Loosely secure through the holes drilled in step 9, using M10 x 1.25 x 30mm hex bolts (2), M10 x Ø30mm flat washers (4) M10 spring washers (2) & M10 nyloc nuts (2).

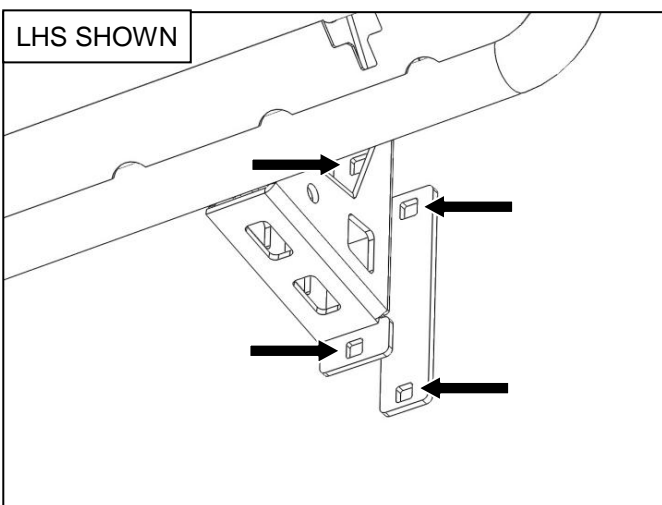

12. With the assistance of another person, carefully lift the LH Rock Crawler Rail into position & re-install the fasteners from step 4, securing through the respective OE components (tighten the fasteners so that they hold firm, but still allow adjustment).
13. On the LHS of the vehicle, so as to sandwich the chassis rail, align the rear mount clamp plate with the rear mount & loosely secure it in place, using M10 x 1.25 x 90mm hex bolts (2), M10 x Ø30mm flat washers (4), M10 spring washers (2) & M10 nyloc nuts (2).

For further information contact T.J.M. Head Office on (07) 3865 9999. Distributors Australia wide.



FITTING INSTRUCTIONS

Product:

Rock Crawler Rails

Vehicle:

Jeep JK Wrangler 07+ (4 Door)

Part No.

735STRSA36Z

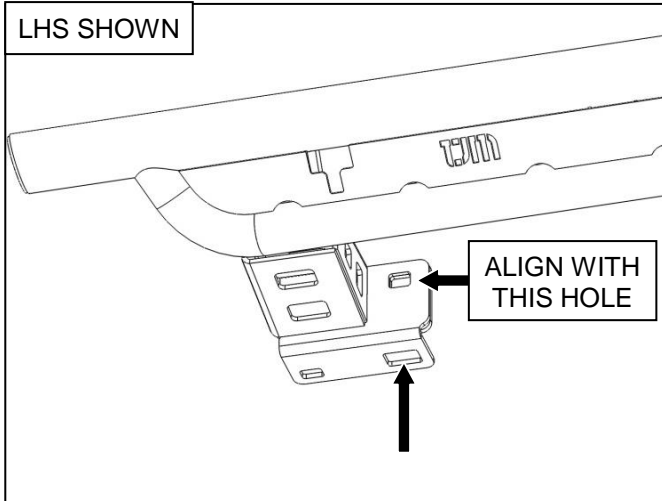

14. On the LHS of the vehicle, insert an M10 x 1.25 nutplate-on-wire into the large square opening in the lower face of the front chassis rail mount & aligning it with the indicated hole, loosely secure it in place, using an M10 x 1.25 x 30mm hex bolt (1), M10 x Ø30mm flat washer (1) & M10 spring washer (1) (tighten the fasteners so that they hold firm, but still allow adjustment).

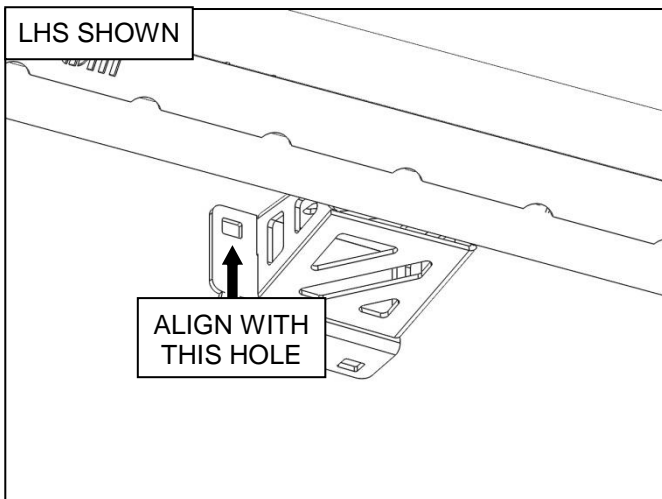

15. On the LHS of the vehicle, insert an M10 x 1.25 nutplate-on-wire into an appropriate opening on the inside of the chassis rail & aligning it with the indicated hole, loosely secure it in place, using an M10 x 1.25 x 30mm hex bolt (1), M10 x Ø30mm flat washer (1) & M10 spring washer (1).

If no cross-member welding is evident behind the centre mount (centre mount is sitting approx. 5mm off chassis rail), install the spacer plate between the mount & chassis during this process.



16. Align the Rock Crawler Rails to the vehicle, confirming that the height & angle is suitable, then tighten the installed fasteners to the appropriate torque settings & ensure that as a result of fitting the product, no vehicle components are crushed or will chafe.

For further information contact T.J.M. Head Office on (07) 3865 9999. Distributors Australia wide.